



Location of Proposed Works

Property Assessment Roll No.: B _____

Municipal Street Address: _____

Structure Identification No.: _____

Legal Description of Property: _____

Property Coordinates in Lat/Long or UTM (Optional): _____

Other Identifier (ex. road crossing): _____

Proposed Works

- | | | |
|--|---|--|
| <input type="checkbox"/> Place or remove fill, or grading | <input type="checkbox"/> Construct new building | <input type="checkbox"/> Addition/renovation of building |
| <input type="checkbox"/> Erosion control or shoreline work | <input type="checkbox"/> Septic system install | <input type="checkbox"/> Construct pond or reservoir |
| <input type="checkbox"/> Change a watercourse (e.g. crossing, relocation, culvert, bridge) | <input type="checkbox"/> Install dock | |
| <input type="checkbox"/> Other (please specify): _____ | | |

Project Details

Description of proposed works: _____

Proposed start date: _____ Anticipated date of completion: _____

Existing use of land (i.e. vacant, residential, etc.): _____

Proposed use of land: _____

Are there SNC permits for prior work at the property?	Yes	No	_____
Is municipal planning approval required for the proposed works? (include Municipal File Number)	Yes	No	_____
Have you confirmed with the municipality whether the zoning permits the proposed development?	Yes	No	_____
Does the work require authorization from other agencies?	Yes	No	_____
Is a municipal building permit required?	Yes	No	_____
Is a septic system building permit required?	Yes	No	_____



For Construction, Renovation, Change in Use of Building/Structure

Existing Footprint: _____ Proposed Footprint: _____
 Current Use of Building: _____ Proposed Use of Building: _____

For Placement of Fill, Fill Removal / Dredging, Site Grading

Placement	Removal	Site Grading				
Type of fill:	Sand	Gravel	Crushed Stone	Quarry Stone	Topsoil	Other: _____
Amount of Fill (m3):	_____	Length of Area (m):	_____	Width of Area (m):	_____	Fill Depth (m): _____

For Culvert Installation / Replacement

Current Culvert Type: _____ Current Culvert Size: _____
 Proposed Culvert Type: _____ Proposed Culvert Size: _____
 Culvert Material: (ex Corrugated Steel Pipe): _____
 Length of Culvert (m): _____ Diameter of Inlet/Outlet (mm): _____

Agent Authorization

This agent authorization section must be completed and signed by the property owner(s) if this application is submitted by an agent on behalf of the owner(s) or if the proposed works are to be carried out by an agent on behalf of the owner(s). If the owner is a corporation acting without an agent, the application must be signed by an officer of the corporation and the corporation's seal (if any) must be affixed.

Note to the owner(s): If the application is prepared by an agent, authorization should be withheld until the application and any supporting documents have been examined and approved by you, the owner(s).

I/We, _____ [print owner(s)'sname(s)], hereby authorize _____ [print agent's name or organization], to provide as my agent any required authorizations or consents, to submit the enclosed application to SNC, and to appear on my behalf at any hearing(s) of the application and to provide any information or material required by SNC Staff and the SNC Board of Directors relevant to the application for purposes of obtaining a permit under s.28.1 of the *Conservation Authorities Act*.

Signed at the city/town of _____.

Signature of Property Owner(s): _____ Date: _____

Signature of Property Owner(s): _____ Date: _____

Utility Providers — As appropriate, to be completed by utility providers. The following is considered landowner authorization and SNCA does not require additional documentation.

Right of Way/Public Place (Existing municipal right of way/public place and is permitted as agreed to by the utility company and the municipality or other landowner.)

Non-Road Allowance Occupations (Existing easement, agreement, license, lease, permit or property purchase.)

Private Property/New Subdivision (Project is located on private property that the utility company has been invited onto to install services.)



Terms and Conditions

- I. Permits or approvals may be required from other federal, provincial, and municipal agencies prior to undertaking the proposed work. SNC permission does not exempt the owner/agent from complying with any or all other laws, statutes, ordinances, directives, regulations, or approvals that may affect the proposed work and the property or the use of same.
- II. Fees paid are for application processing only. SNC staff may attach conditions to a permit or refuse a permit based on their interpretation of Part VI of the *Conservation Authorities Act*, O. Reg. 41/24, and SNC Regulation Policies. SNC staff shall not refuse an application for a permit or attach conditions to a permit unless the applicant for the permit has been given an opportunity to request a hearing before the SNC Board of Directors.
- III. SNC may cancel or change a permit granted under Section 28.1 of the *Conservation Authorities Act* if (1) false information was submitted as part of the permit application or (2) the work deviates from the conditions of the permit without SNC's prior written approval.
- IV. An SNC appointed officer may enter on private property, other than a dwelling or building, if the entry is for the purpose of considering permit application. SNC will not enter the property without first contacting the landowner for permission.

I/We the undersigned hereby certify to the best of my/our knowledge and belief that all the above-noted, attached and/or supporting documentation information is correct and true. I/We further solemnly declare that the contents of the application and specifically the terms and conditions, and the declaration which is written below have been read.

By signing this application, the owner(s) grants SNC, its employees, and authorized representatives' access to the property for the purposes of obtaining information and monitoring any approved works. SNC will not enter the property without first contacting the landowner for permission.

Name of Owner(s): _____

Signature: _____

Date: _____

Name of Agent: _____

Signature: _____

Date: _____

Collection of Information

Personal information is collected in accordance with Part VI of the *Conservation Authorities Act* and O. Reg. 41/24. Information submitted in this application may be disclosed to departments or agencies of local, provincial, or federal government for review and comment. It may also be disclosed to members of the public in accordance with the requirements of the *Municipal Freedom of Information and Protection of Privacy Act*, R.S.O. 1990, c. M.56. Questions about the collection of information should be directed to South Nation Conservation.



Sample Site Plan

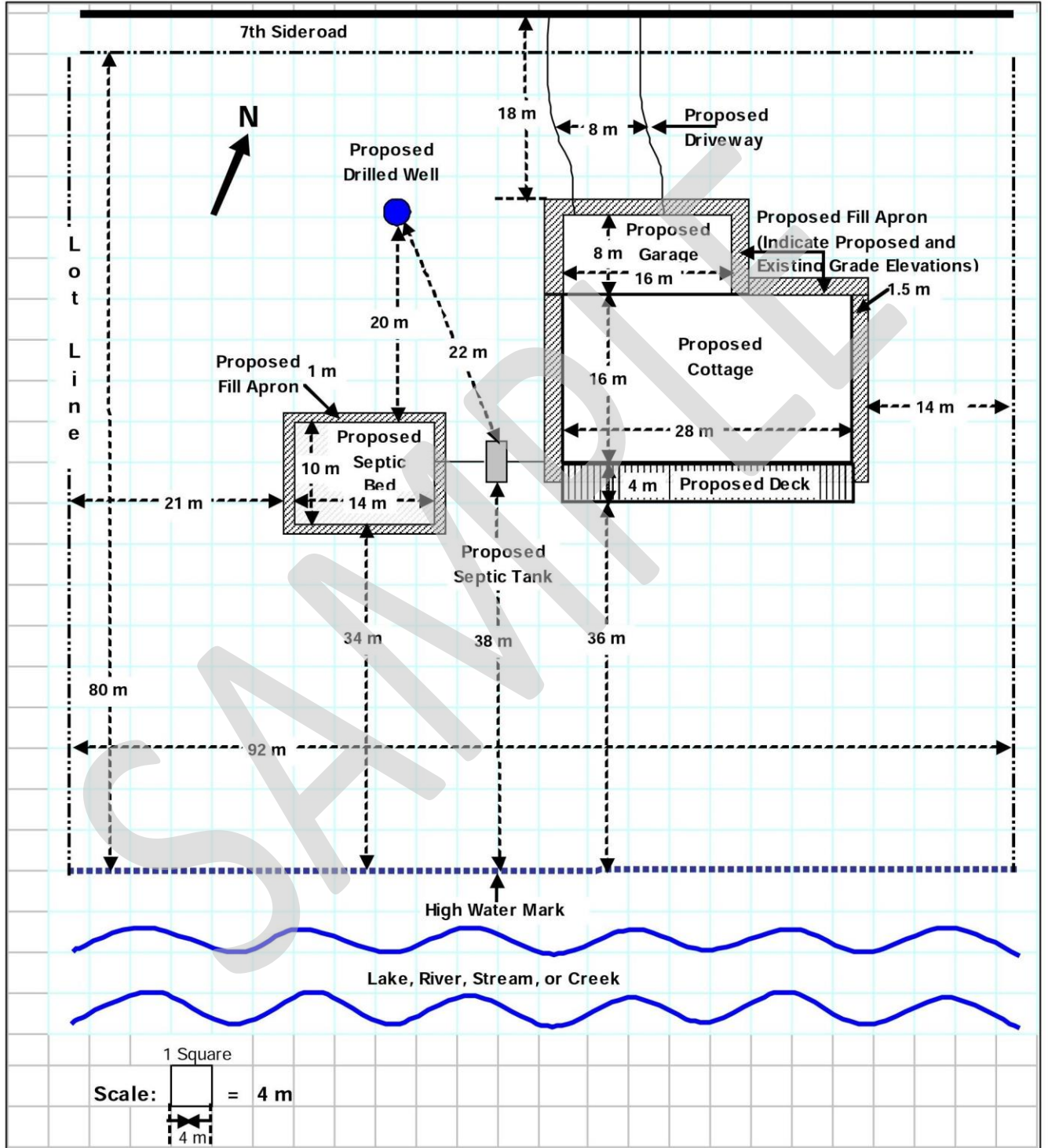

This sample site plan is not for design purposes. It is an example to illustrate the minimum level of detail required to enable SNC to process permit applications.



Sample Drawings

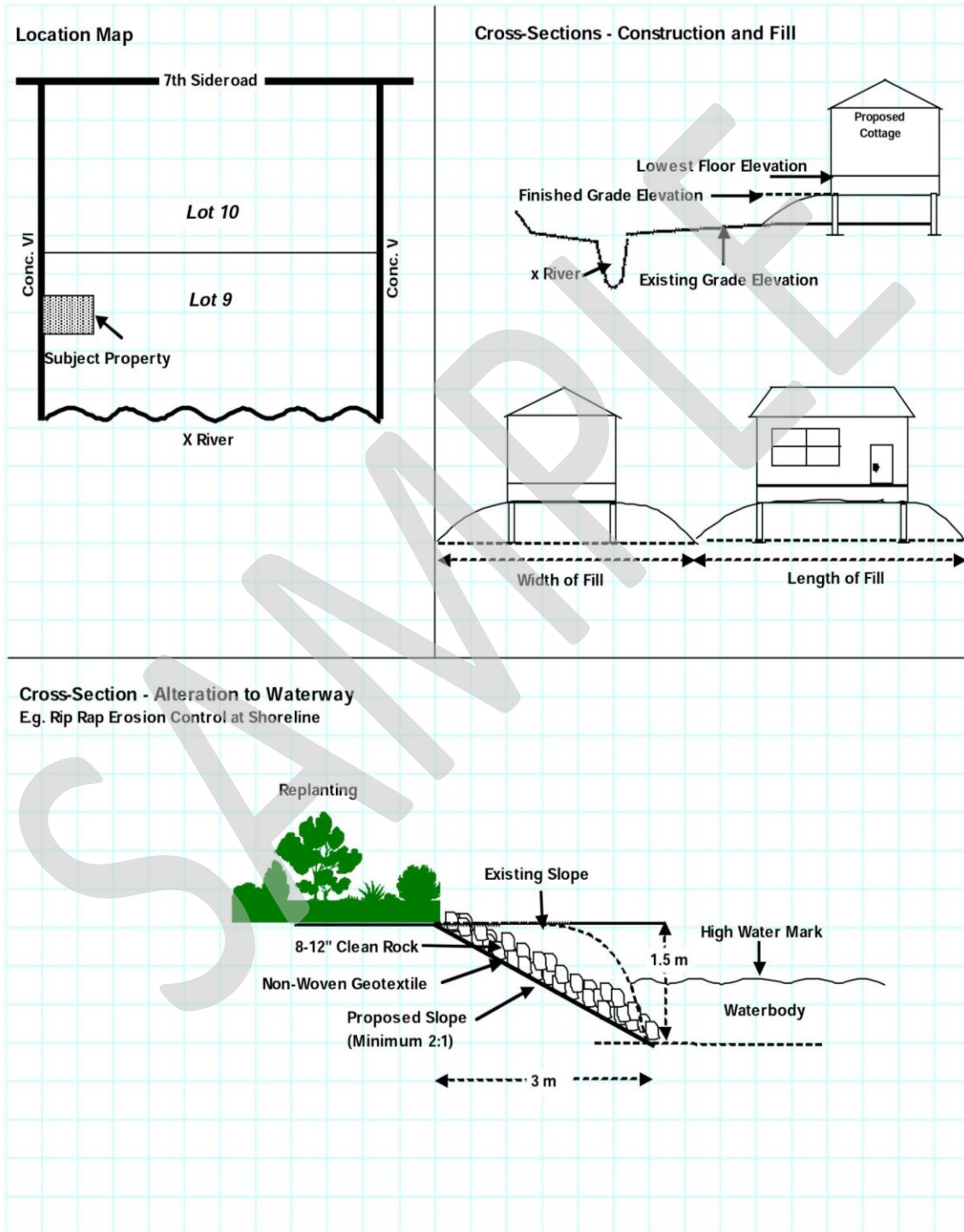

These sample drawings below are not for design purposes. They are examples to illustrate the minimum level of detail required to enable SNC to process permit applications.